

[masalletebain.com](http://masalletebain.com)

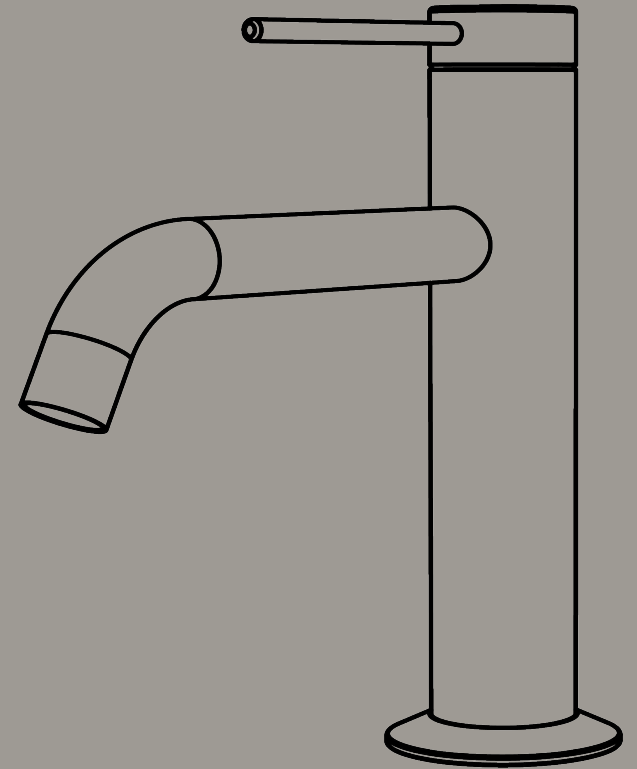







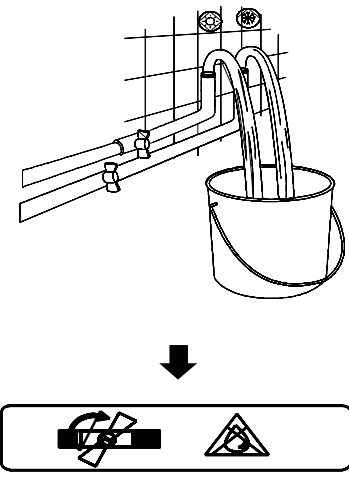
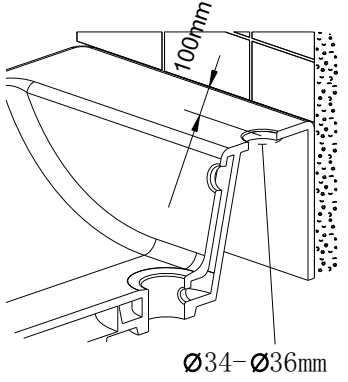

masaldebain.com

Nous vous remercions,

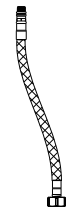
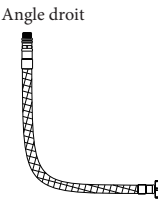
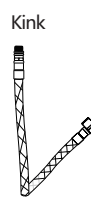
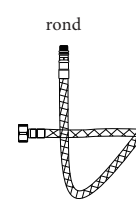
d'avoir choisi les produits masaldebain.com, et de la confiance que vous nous accordez. Afin d'assurer une installation optimale, nous vous invitons à suivre attentivement les instructions renseignés dans ce document. Notre équipe est à votre disposition pour toute assistance complémentaire.

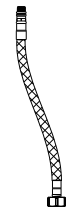
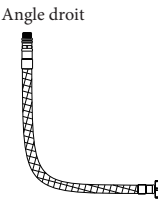
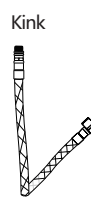
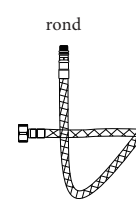
Thank you,

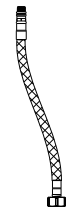
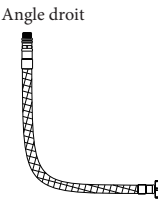
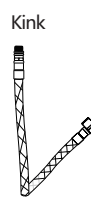
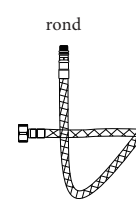
for choosing masaldebain.com products, and for the trust you have placed in us. To ensure optimal installation, we invite you to carefully follow the instructions given in this document. Our team is available for any further assistance you may need.

											
<b>Spécifications du produit</b> Pression minimale 0.5bar Pression maximale 6.0bar	REMARQUE: VANNES D'ISOLATION NON FOURNIES 										
<b>Nettoyage</b> Toutes les surfaces doivent être nettoyées à l'aide d'un chiffon propre et humide. N'utilisez pas de produits ou de matériaux abrasifs.											
<b>Tuyaux de raccordement flexibles</b> Il convient de veiller, lors du raccordement des tuyaux flexibles à la tuyauterie domestique, à ce qu'ils ne soient pas pliés de manière trop prononcée et qu'ils ne soient pas tordus ou vrillés. <table border="0" data-bbox="1299 1117 2072 1420"><tr><td>Légère courbure</td><td>Angle droit</td><td>Kink</td><td>Courbé rond</td><td>Torsions</td></tr><tr><td></td><td></td><td></td><td></td><td></td></tr></table> <p><b>⚠ Important :</b> Le non-respect de ces consignes peut entraîner des performances médiocres et endommager les tuyaux de raccordement flexibles.</p>		Légère courbure	Angle droit	Kink	Courbé rond	Torsions					
Légère courbure	Angle droit	Kink	Courbé rond	Torsions							
											

①

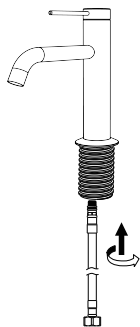

②

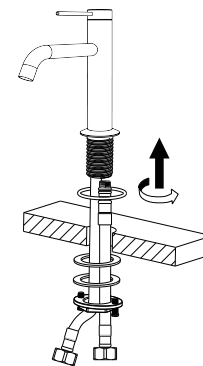

③

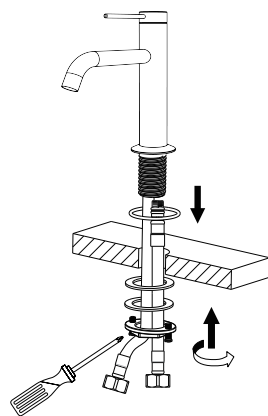

④

